

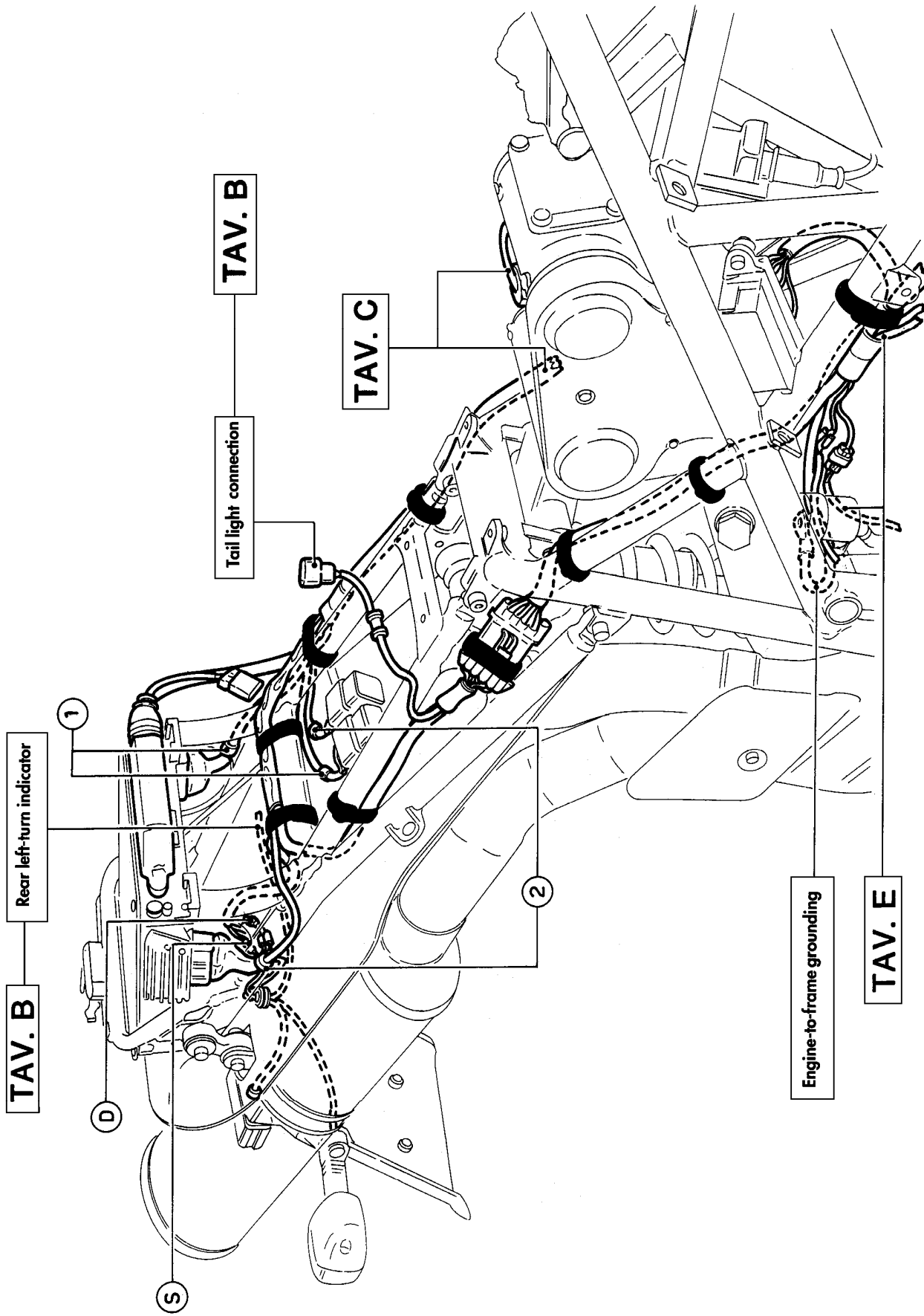

Arrangement of cables and hydraulic lines on the frame.

The models described here are all fitted with waterproof cables and connectors that are the result of years of experimenting under the most difficult working conditions. Furthermore, routing was optimized to save space and reduce weight. The routing of cables in the electric wiring and injection system as well as of hydraulic lines was carefully designed to avoid contact with any parts that may cause damage or malfunction while the bike is running. The tables given below show the critical points and the starting points ("O") for rerouting cables. They also show the positions for the hose clamps and the arrangement of the hydraulic unions in the brake and clutch circuits.

For the purpose of clarity, the system was subdivided into various tables (e.g. TAB.A, TAB.A/1) with different views to give a better picture of the various passages. Each figure reports cross-references to other tables to trace further routing of the cable or line concerned or the unit to which it is connected.



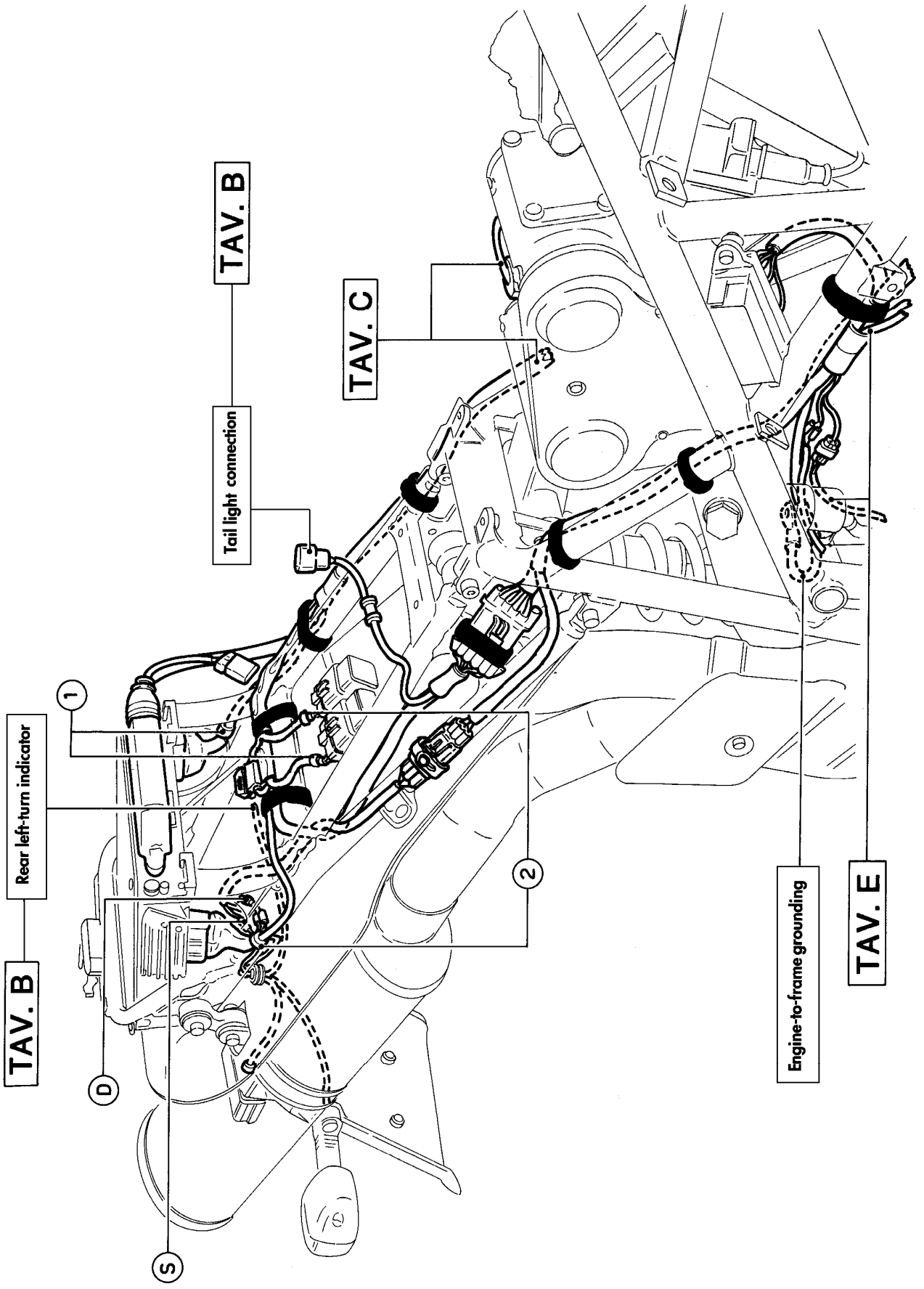

TAV. A

916 S.P. '95

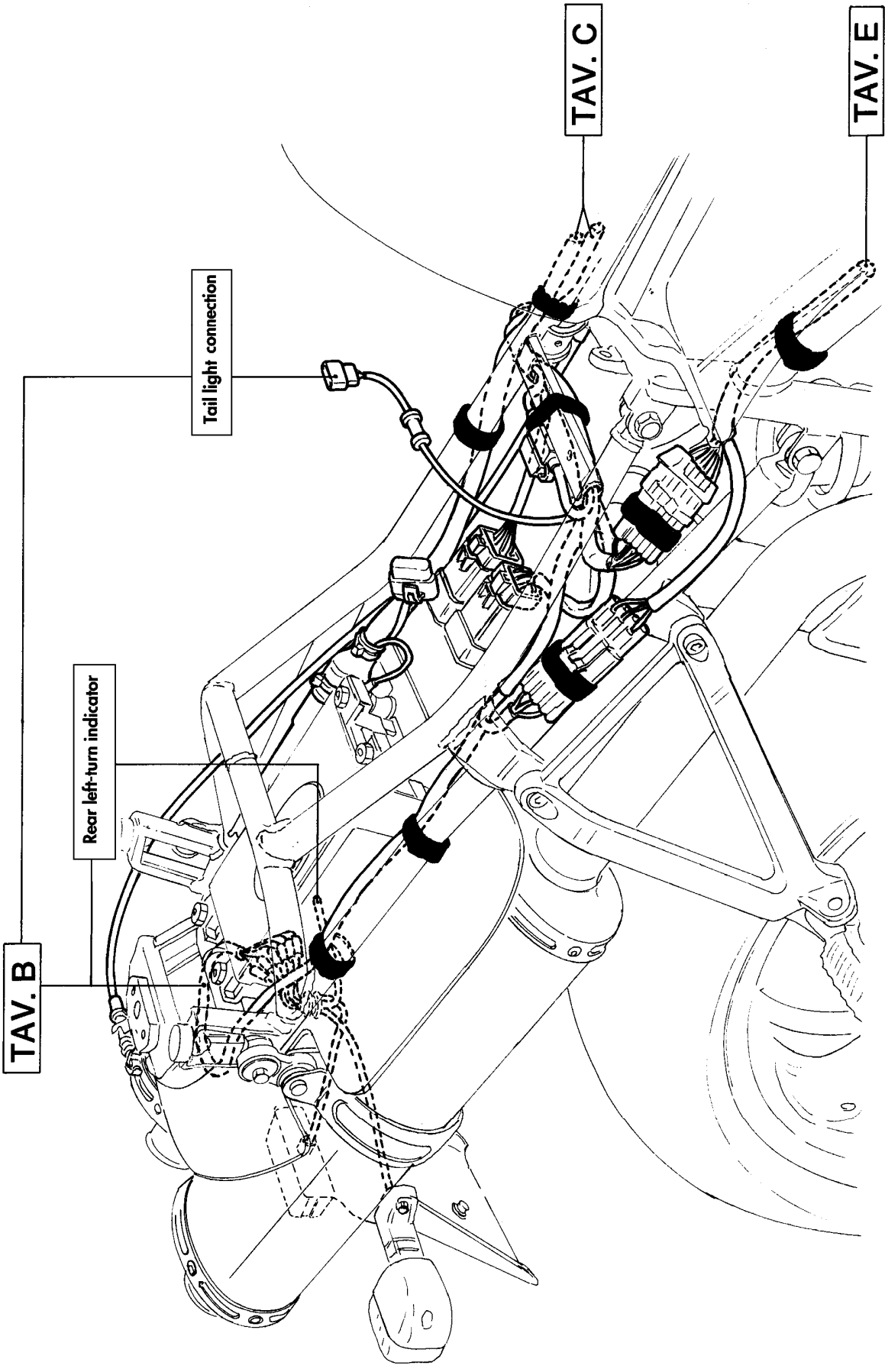

BIP.

TAV. A

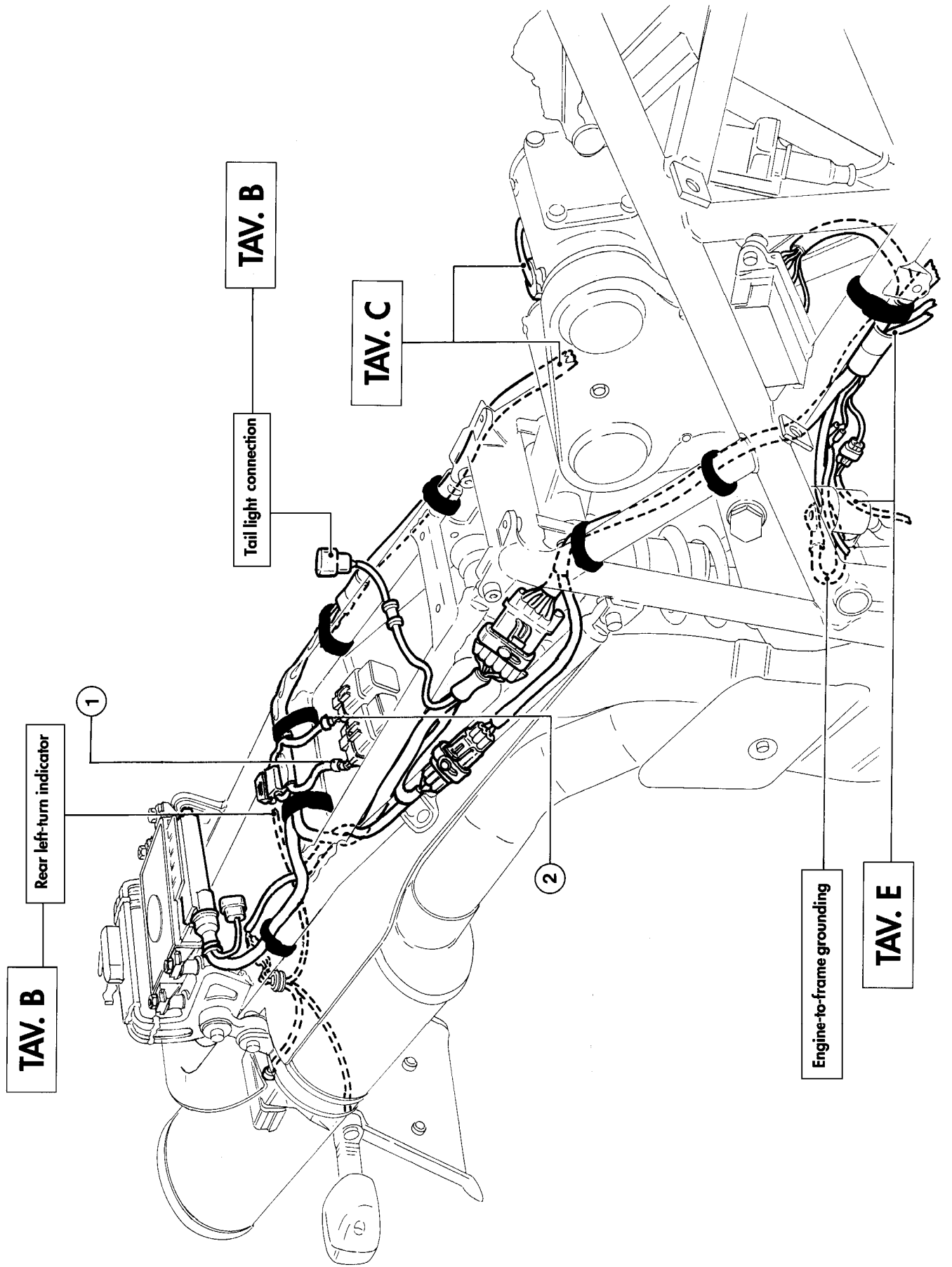

TAV. A

748 STR. / S.P.

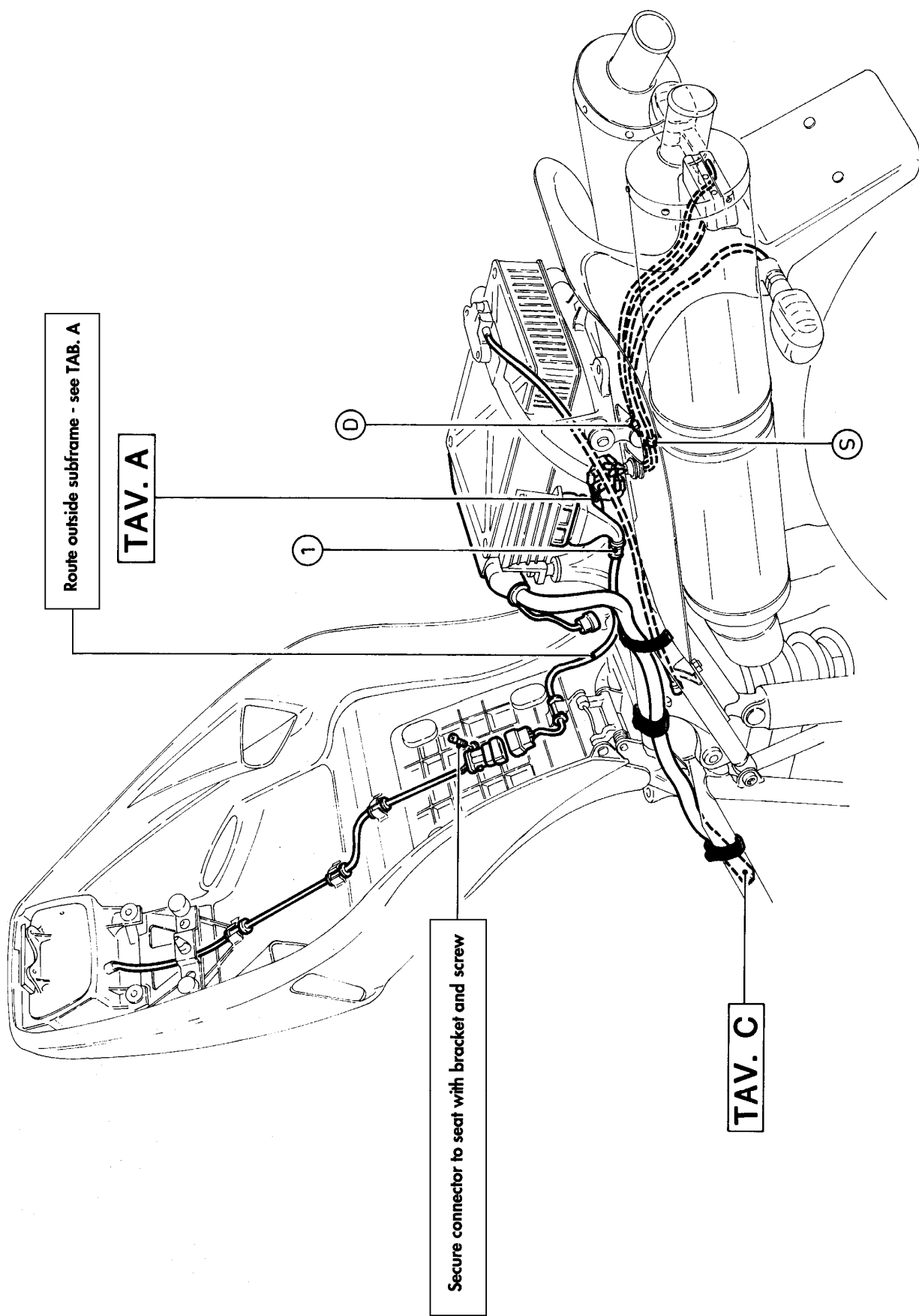

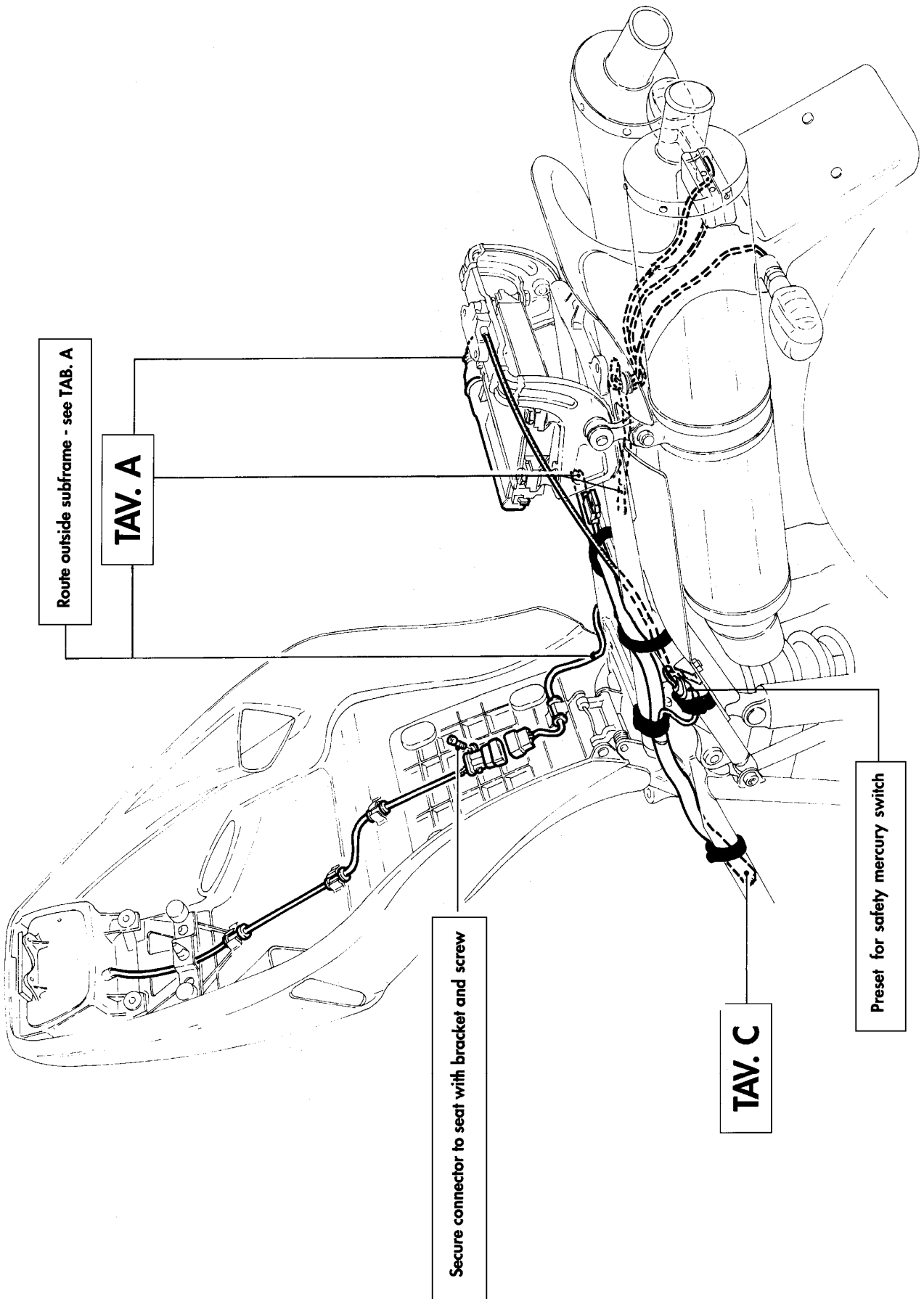

Route outside subframe - see TAB. A

TAB. A

Secure connector to seat with bracket and screw

TAB. C

Preset for safety mercury switch

TAV. B

748 STR. / S.P.

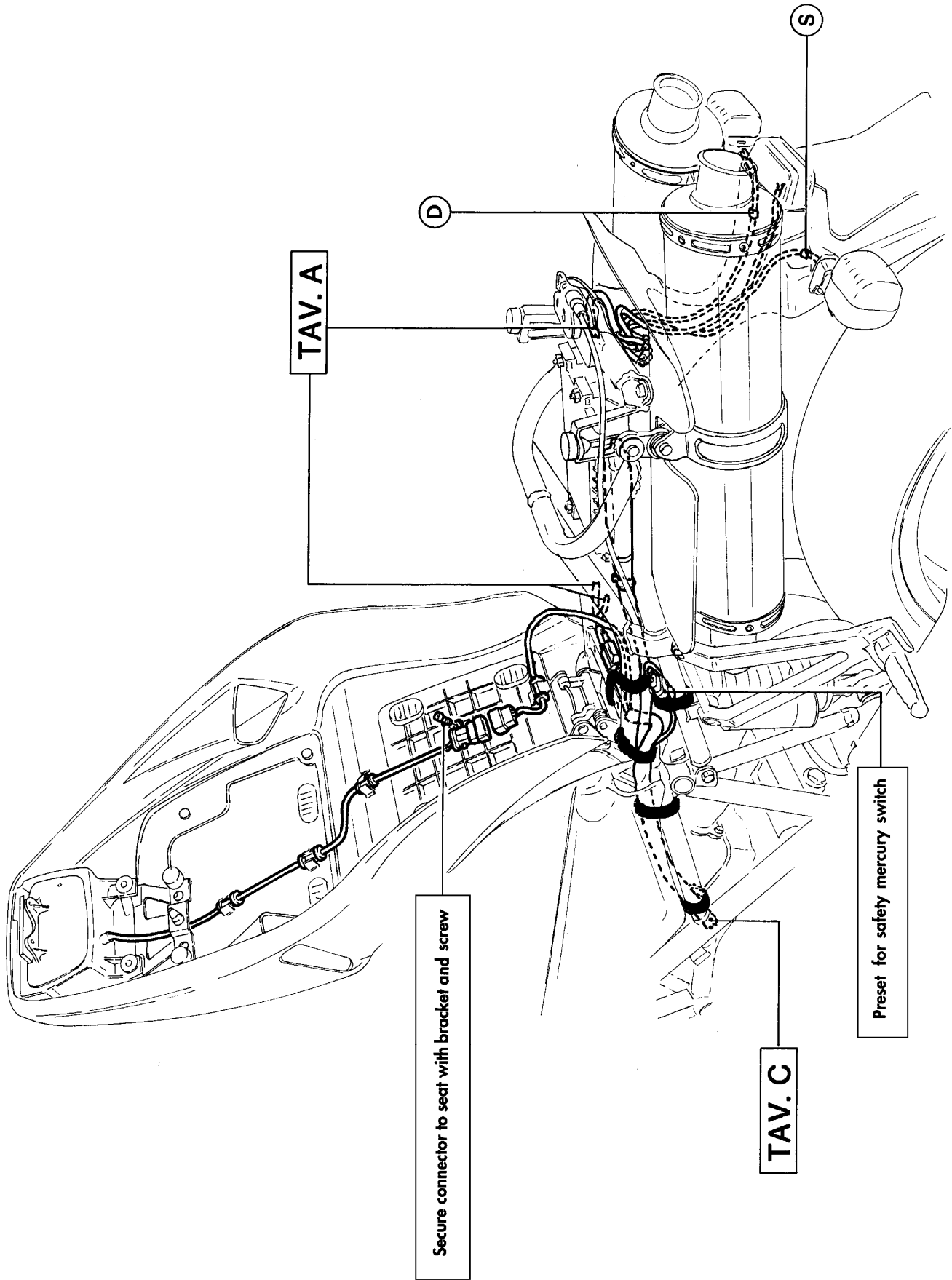

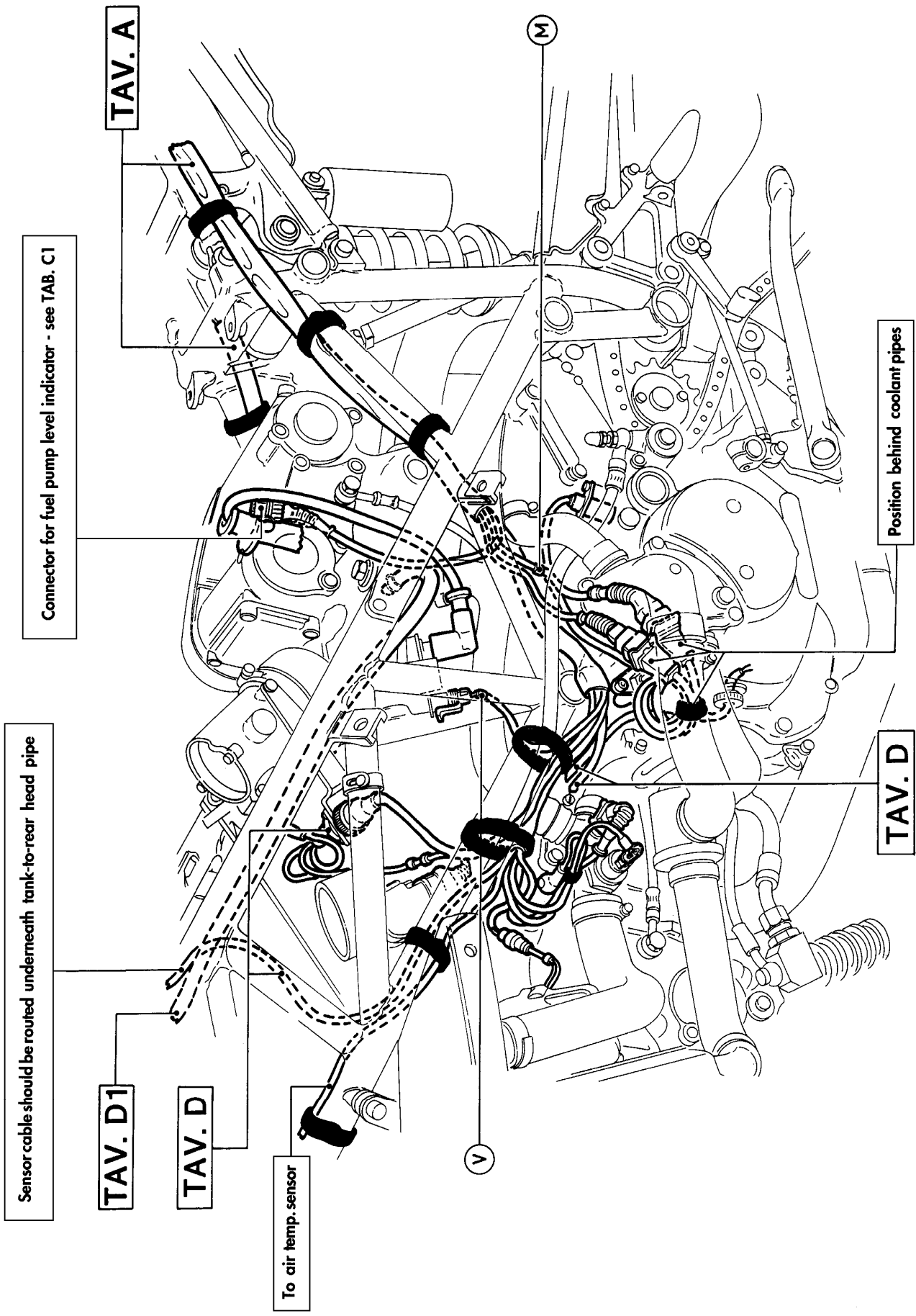

TAV. C

916 STR. / S.P. '94

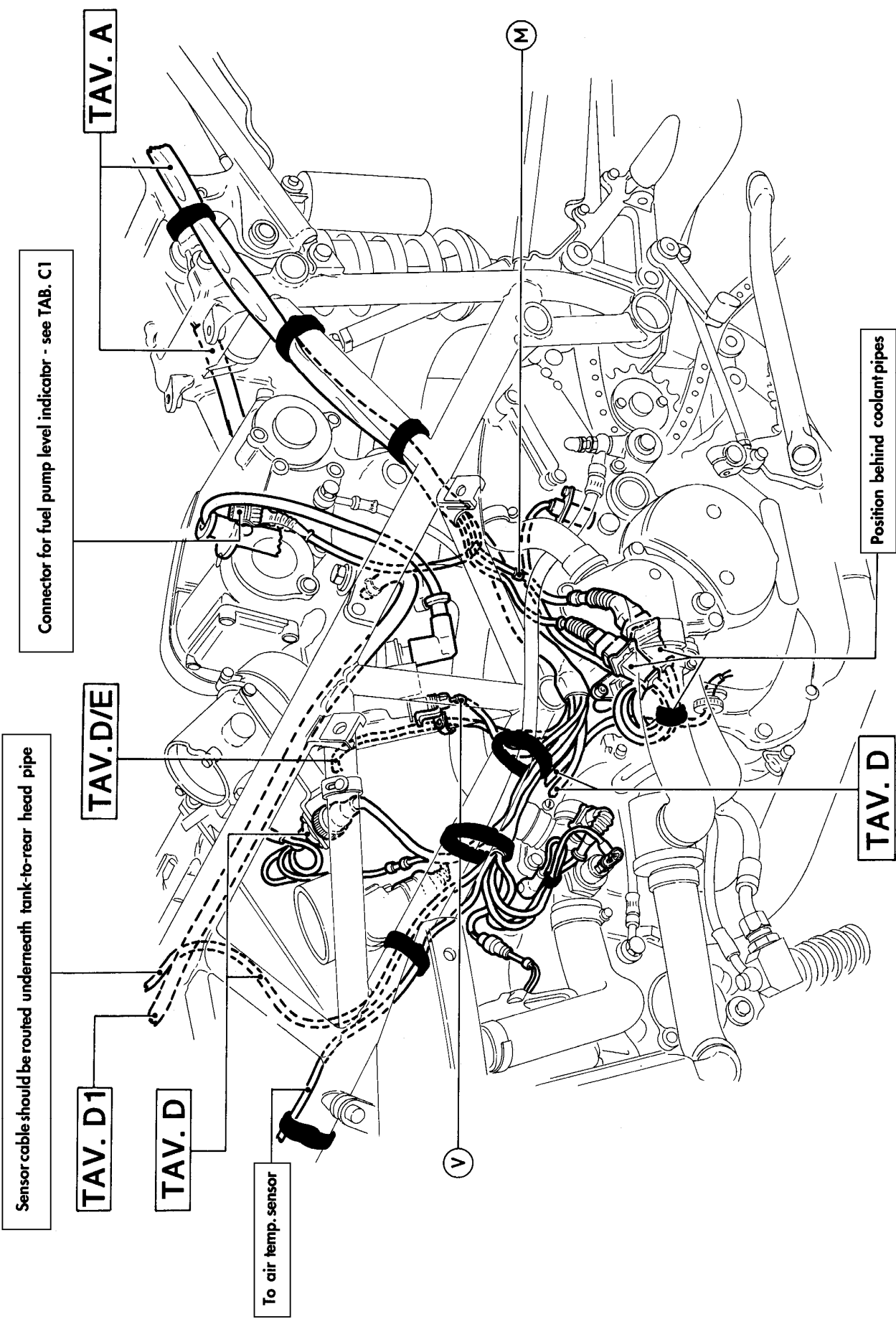

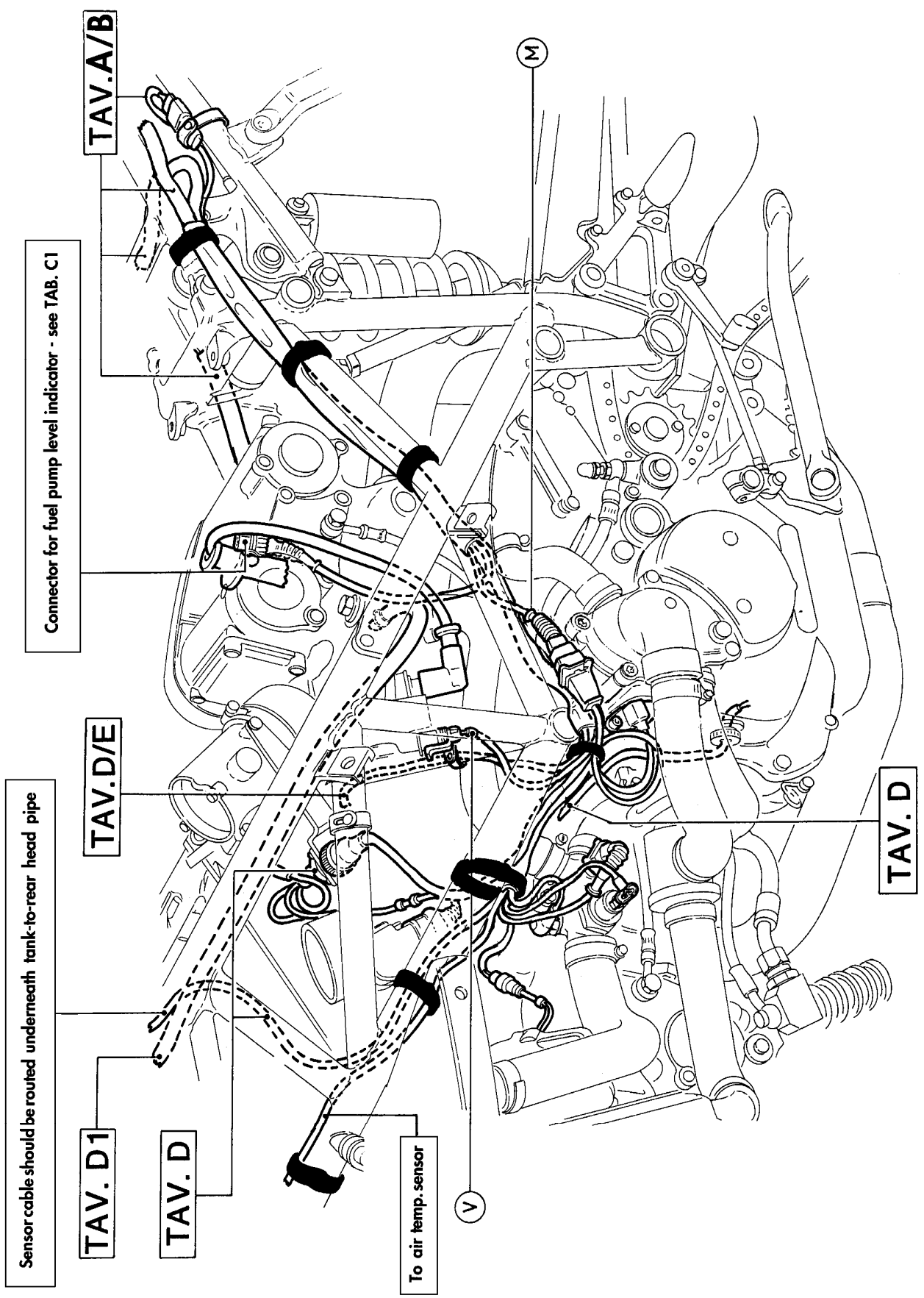

TAV. C

916 S / BIP. - 748

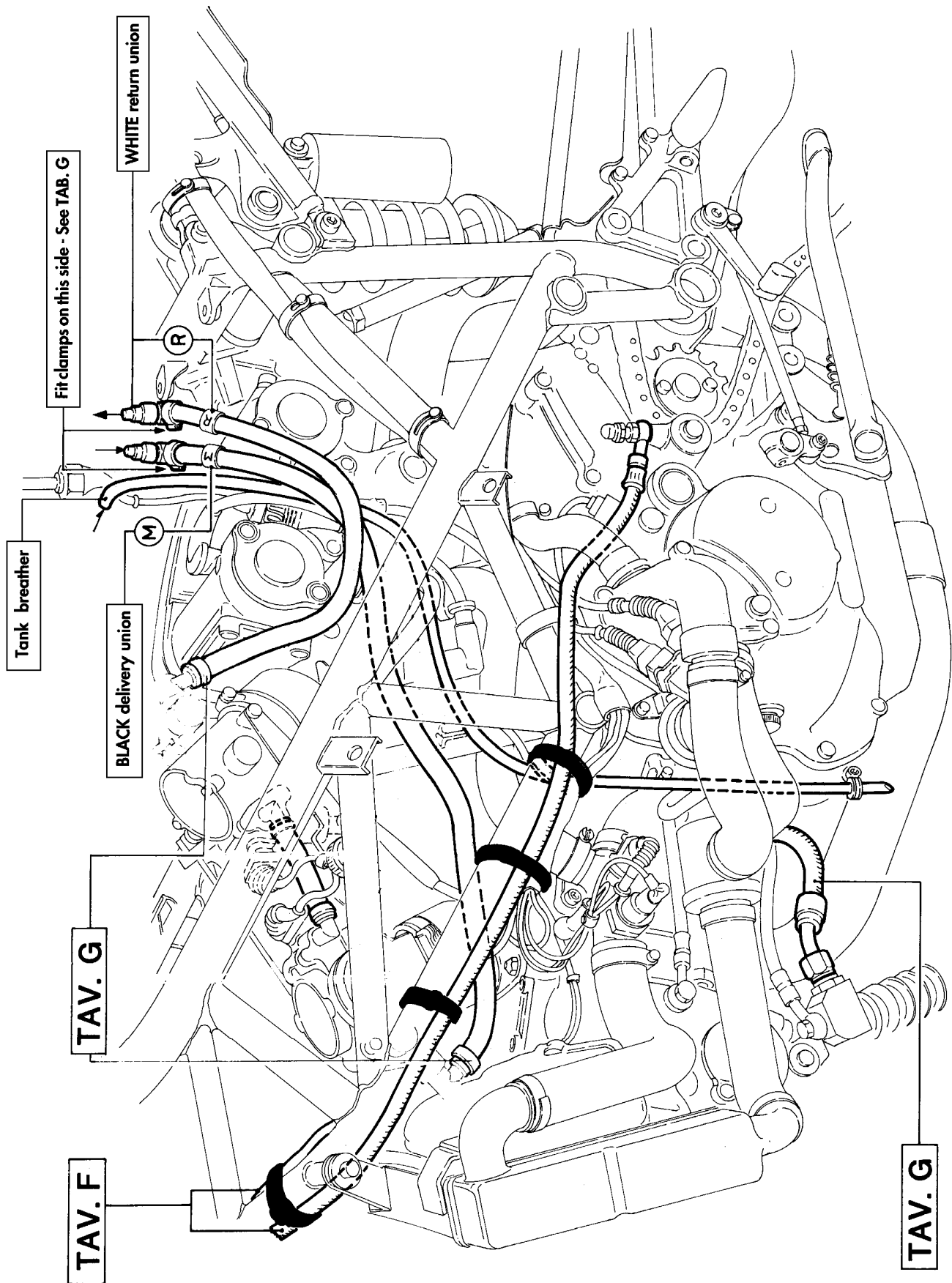

916 S.P.

TAV. C1

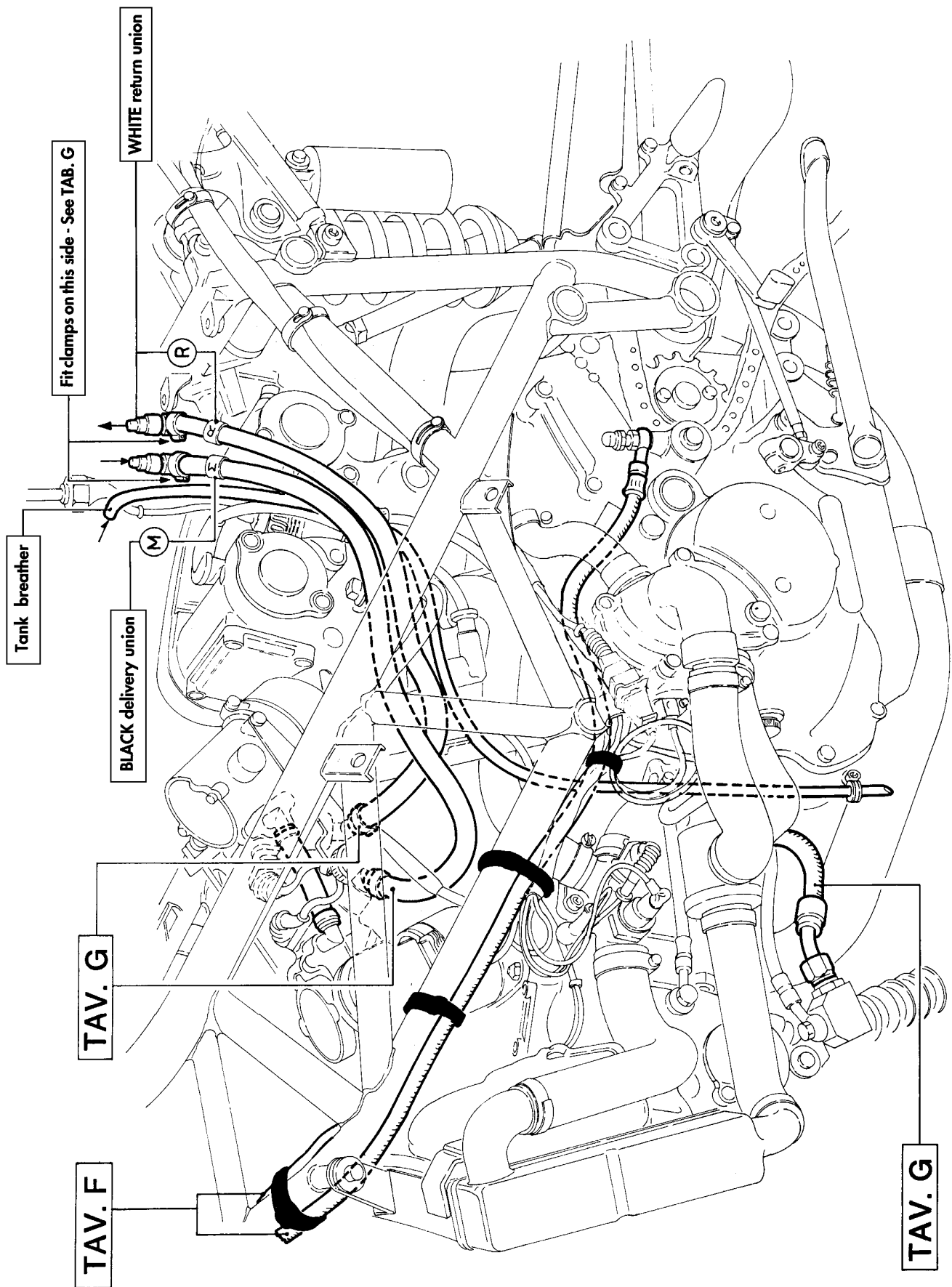

TAV. C1

916 S / BIP. - 748

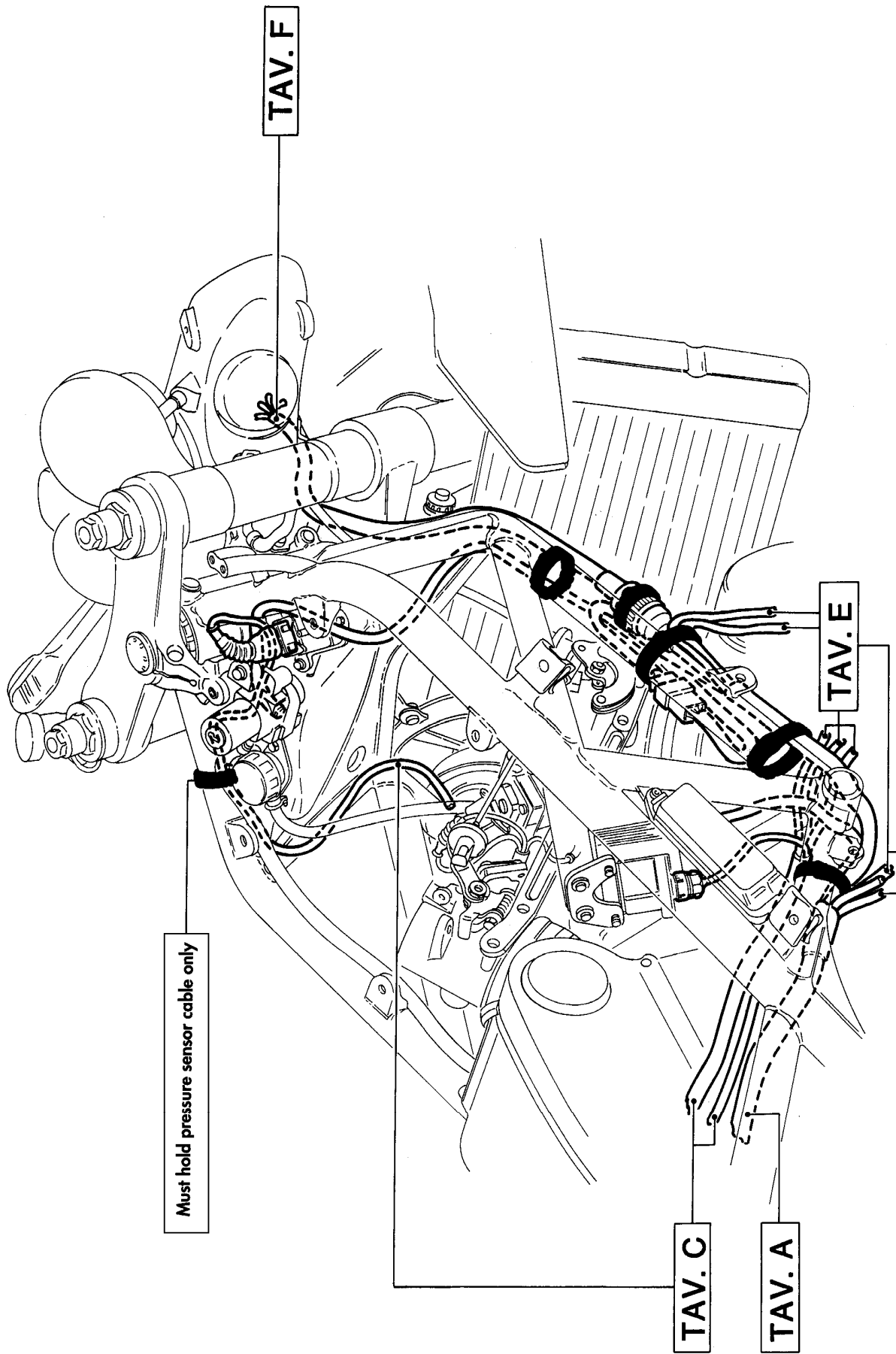

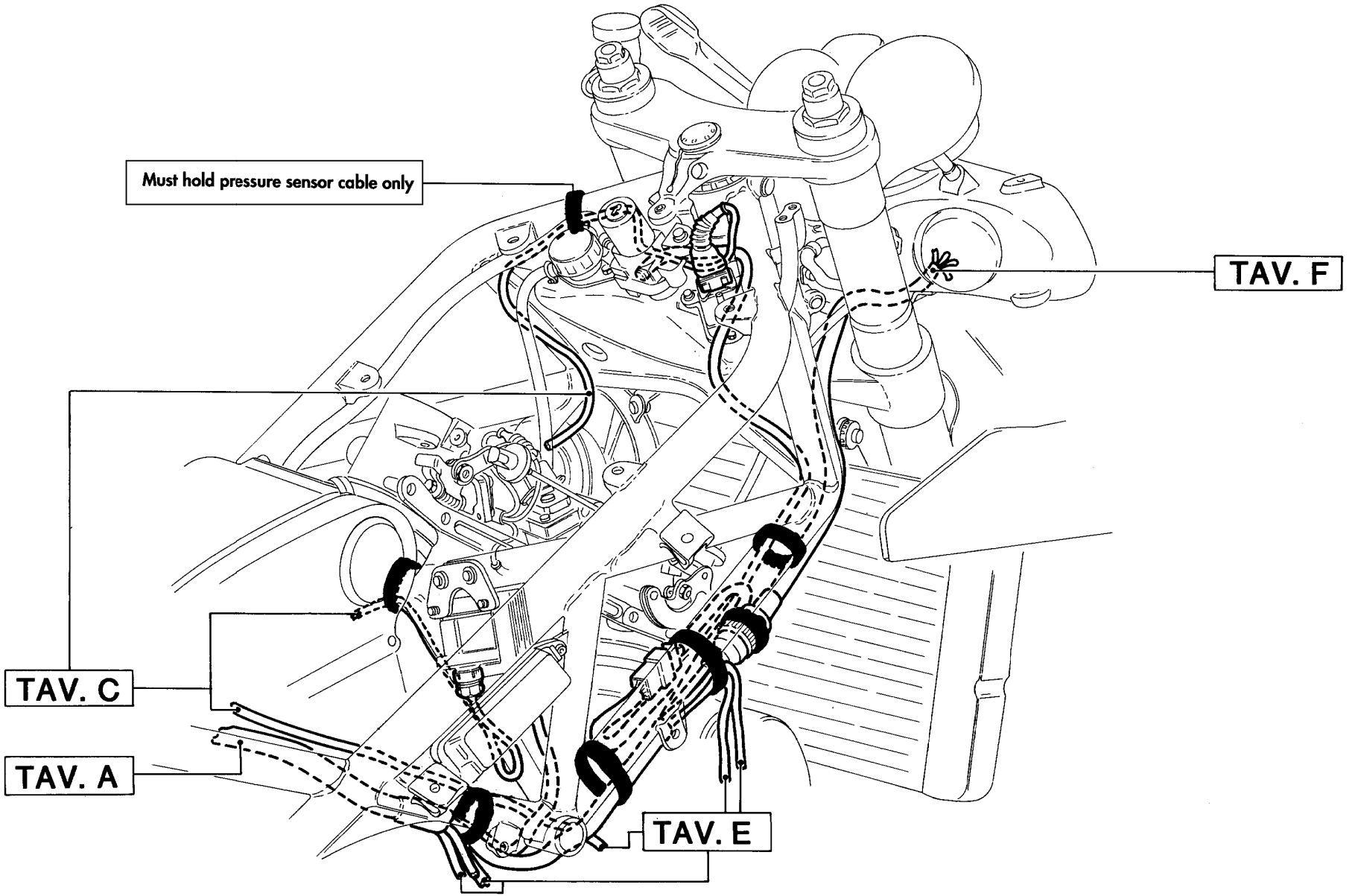

TAV. D

'95

TAV. D1

TAV. C

Expansion tank

Route between steering tube and front wiring

TAV. F

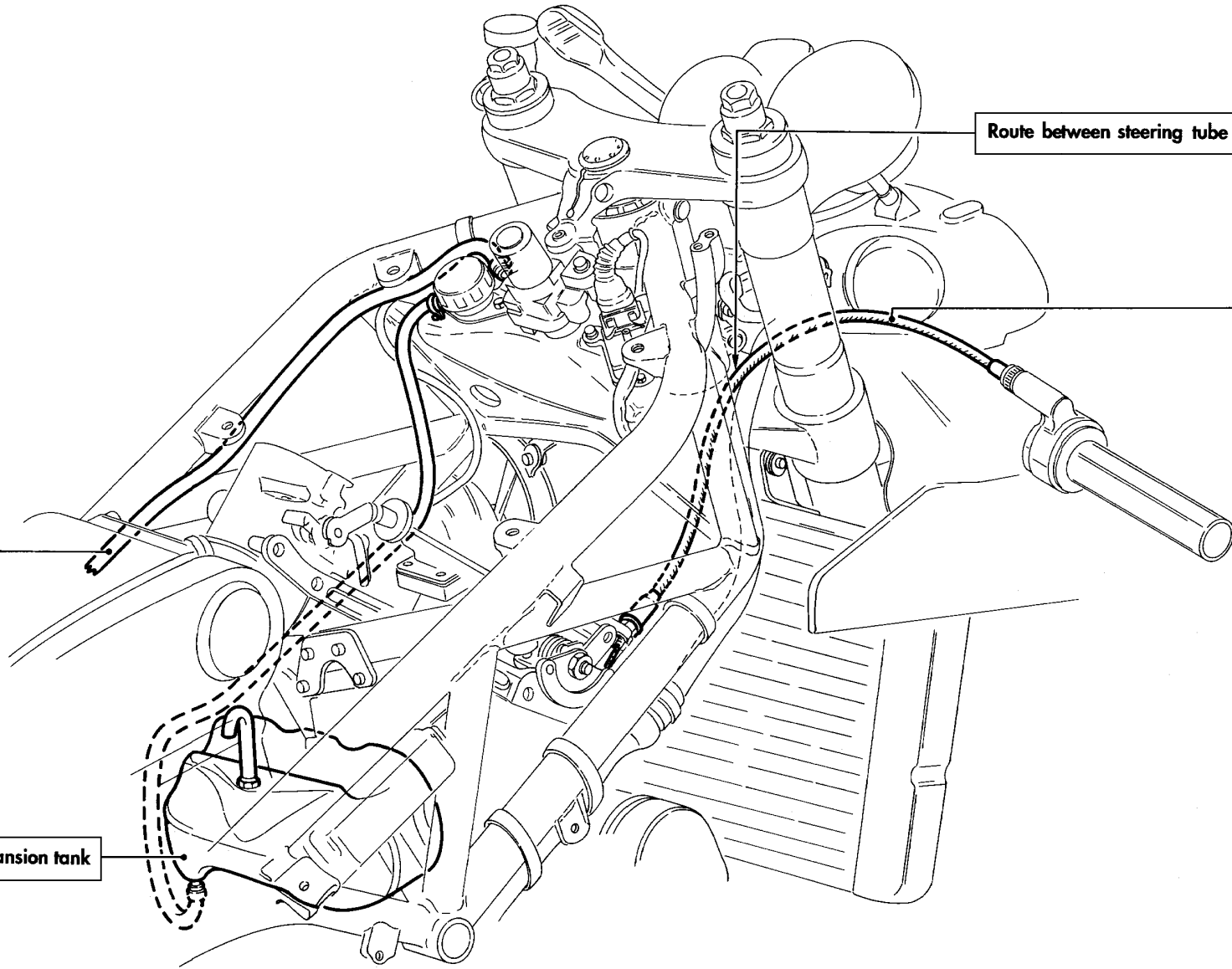

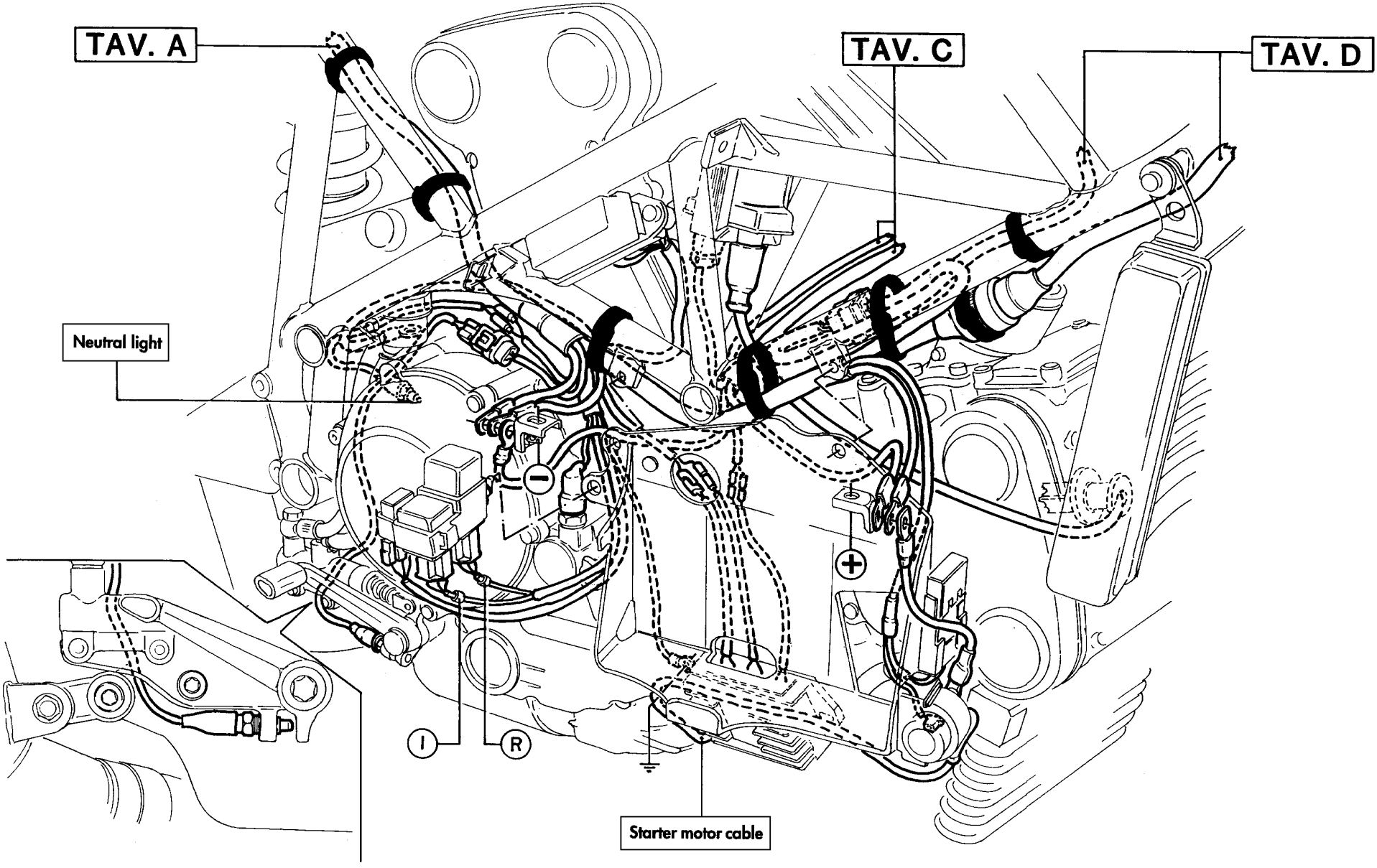

TAV. A

TAV. C

TAV. D

Neutral light

Starter motor cable

I R

+

TAV. E

916 STR. / S.P. '94

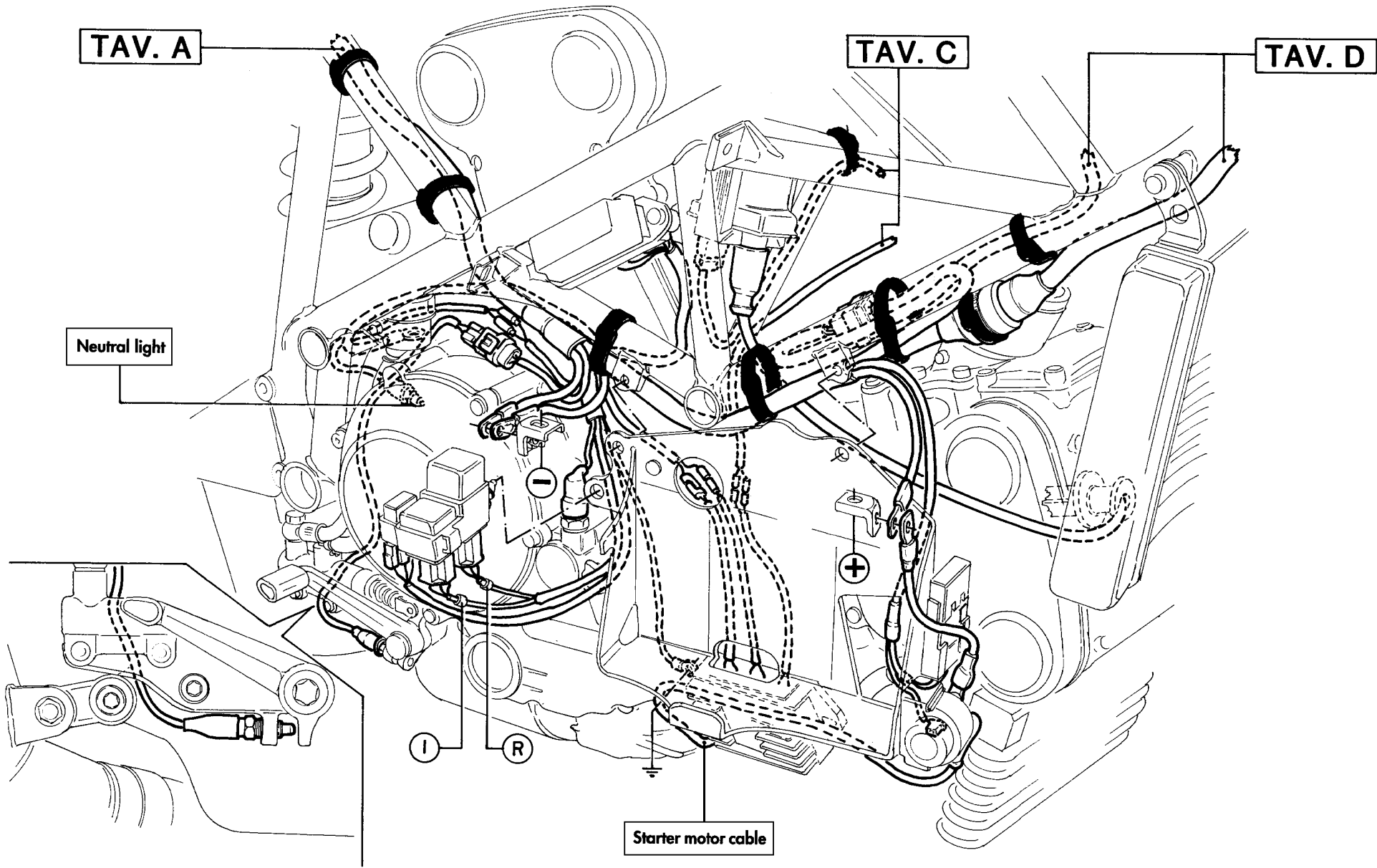

TAV. F

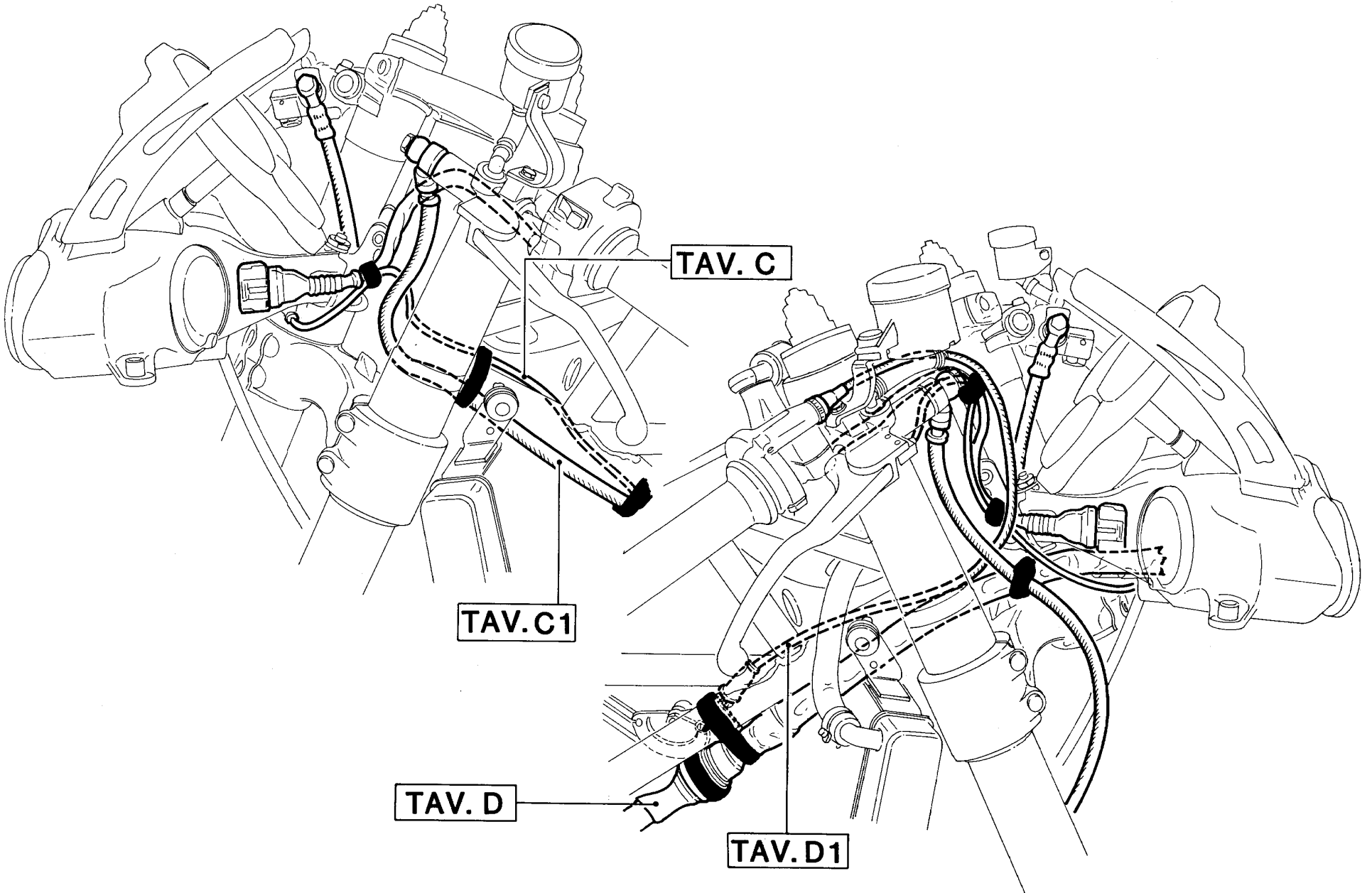

TAV. C

TAV. C1

TAV. D

TAV. D1

Correct arrangement of fuel pipe unions and clamps

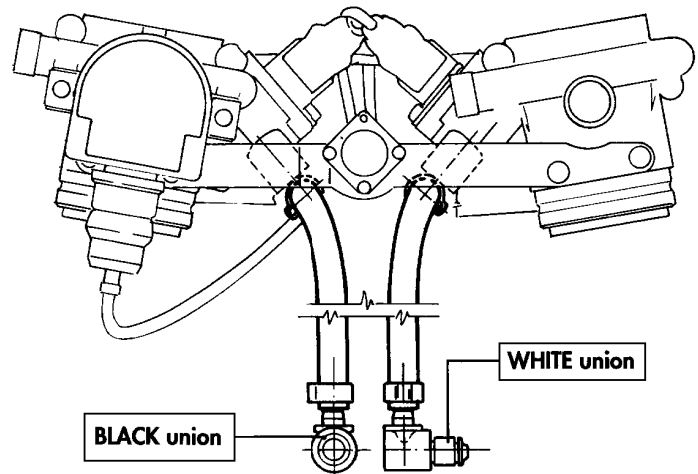

916 S / STR. / BIP. - 748

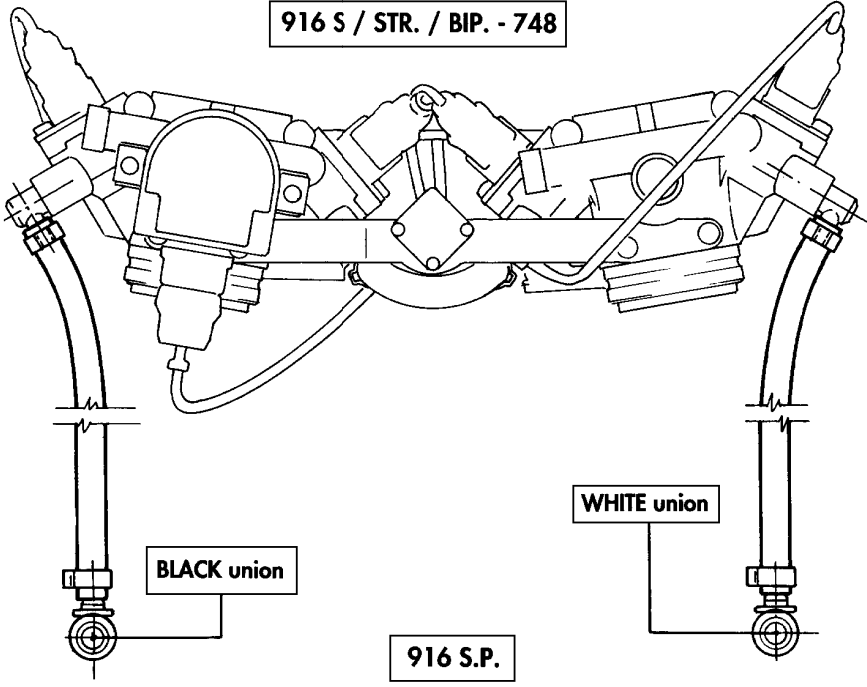

916 S.P.

Connection of tank pipes and cables

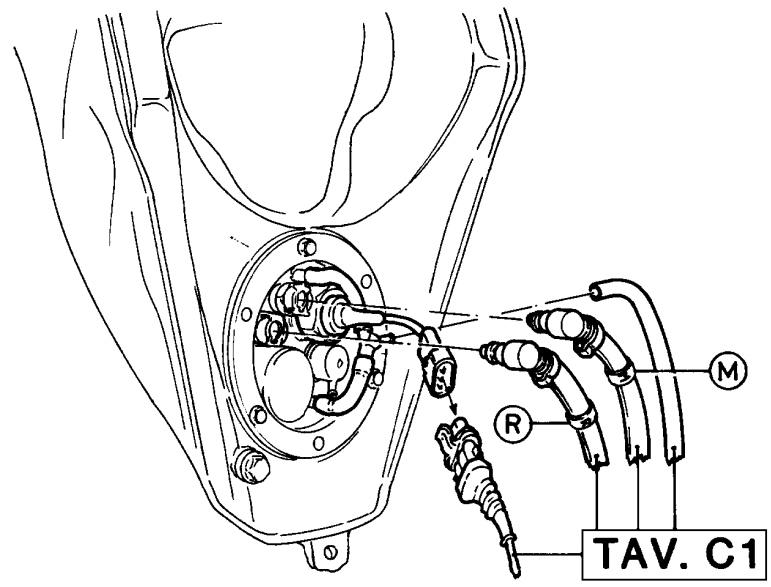

Correct assembly of oil cooler connecting pipes

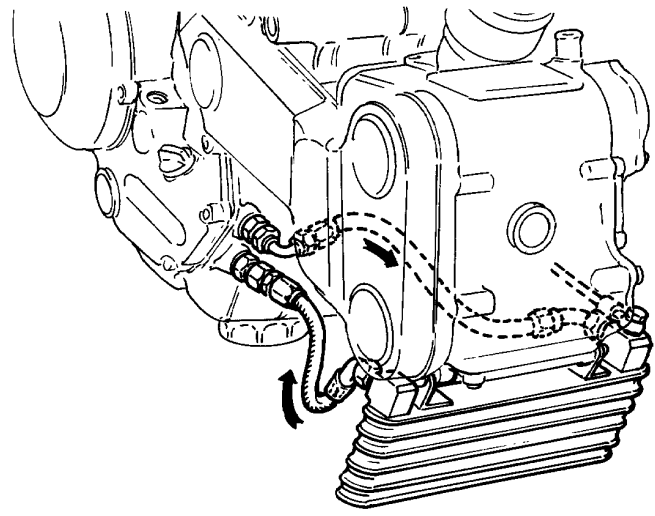

TAV. G

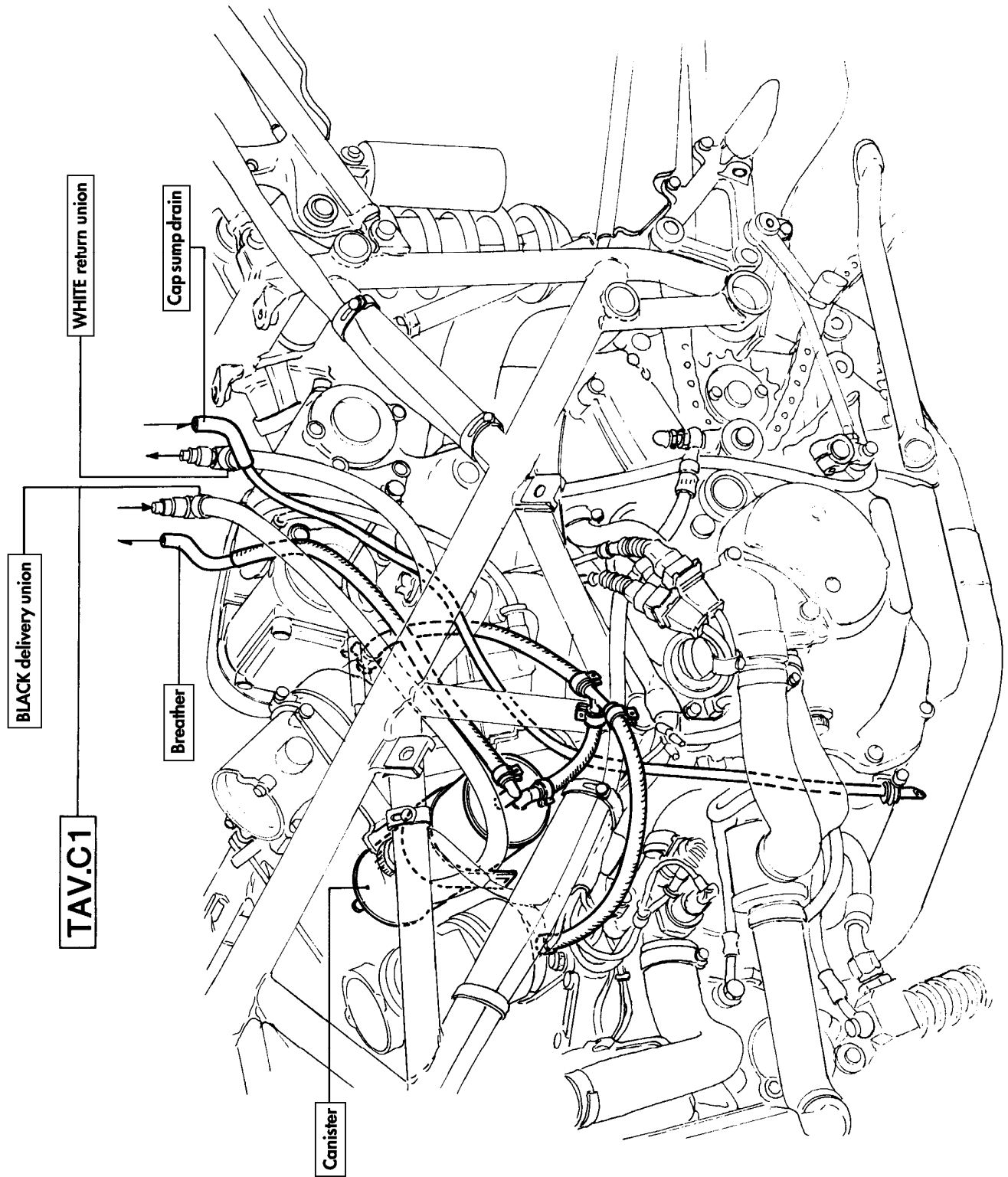

TAV. H

CALIFORNIA